

# ALLIED BOLT PRODUCTS

## Automatic Deadends/Splices and Formed Wire Hardware

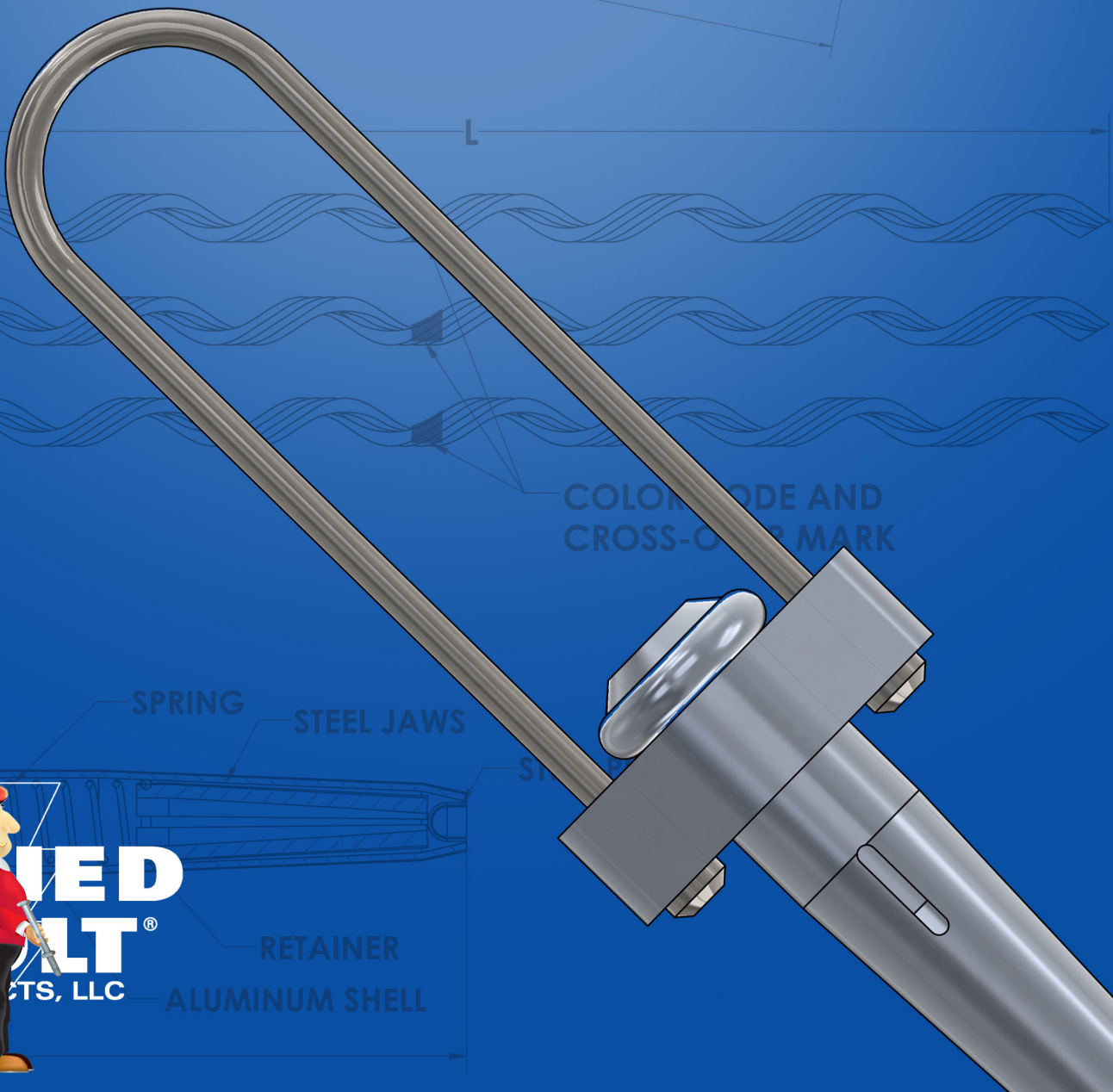

**ALLIED  
BOLT**<sup>®</sup>  
PRODUCTS, LLC

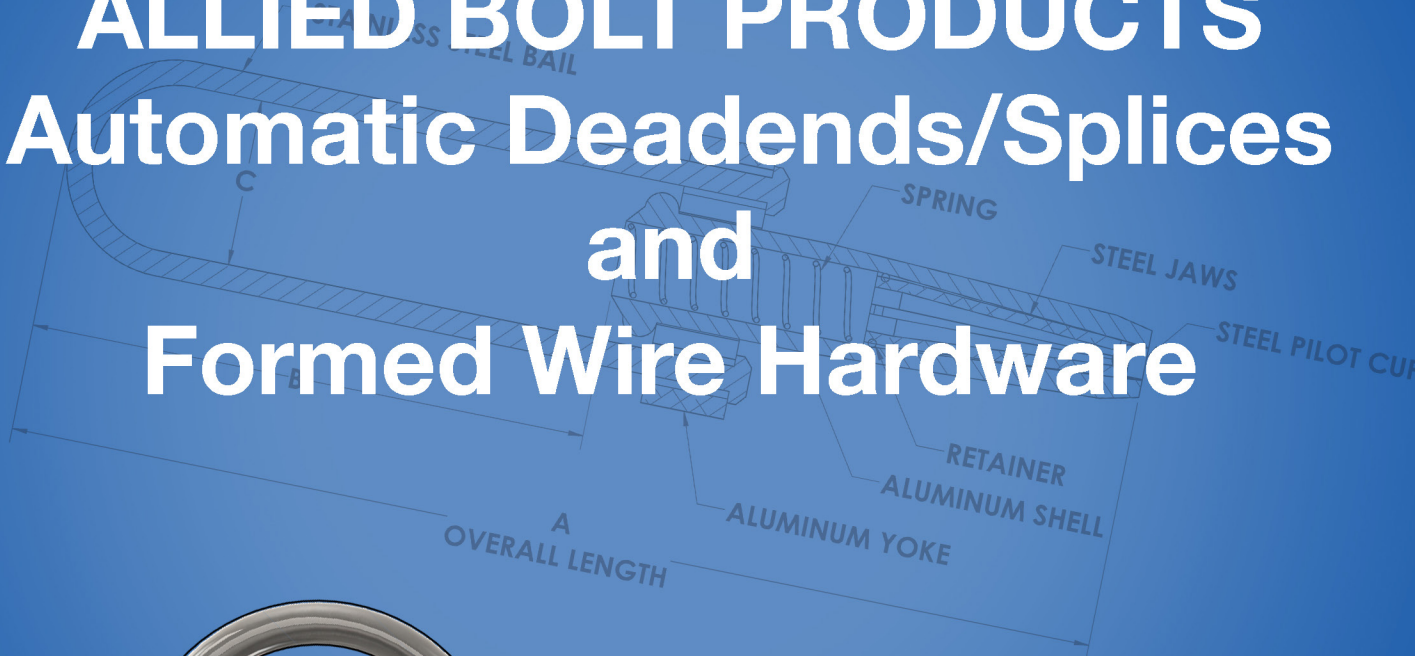

## About Us

Allied Bolt (Referred to as Allied Bolt Products LLC after 2012) is a global supplier of hardware and components that support the telecommunication and power utility industries. Headquartered in Lake Success New York, Allied Bolt currently maintains inventory in North Carolina, Florida, and California. Allied Bolt is incorporated in the State of New York since 1955.

Allied Bolt products are grouped into nine primary categories: Earth Anchors, Poleline Hardware, Aerial Drop Hardware, Drop Attachments, Grounding Hardware, Banding, Tools, Wall Anchors, and Fasteners. These nine product categories safely provide the equipment necessary to bring high speed data, landline phone service, digital television service, satellite television service, and electrical power distribution to urban and rural homes. Allied Bolt also provides products for supporting and maintaining electrical transmission lines.

## Index

### Wire Formed Hardware:

- Guy Wire Deadend..... 1
- Guy Wire Splice..... 2
- False Deadend ..... 3

### Automatic for Steel Guy Strand:

- Automatic Guy Strand Deadend ..... 4
- Automatic Guy Strand Splice..... 5
- Strand Reducing Splice..... 6

### Automatic for Steel Messengered Support Wire:

- Messenger Support Wire Deadend..... 7
- Messenger Support Wire Splice..... 8

### Aluminum Conductor Deadend:

- Z Bail Aluminum Dead-End ..... 9
- Clevis Bail Aluminum Dead-End ..... 10
- Flexible Bail Aluminum Dead-End..... 11

- Aluminum Conductor Splice..... 12

- Automatic Copper Conductors ..... 13

- Strand Sizes..... 14

- Cross Reference..... 15



## Guy Wire Deadend

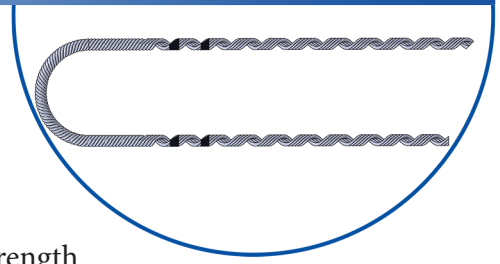

- Provides a means for attaching guy wire to guy hooks, eyebolts, anchor rods, and eye nuts.
- Holding strength is greater than the Rated Breaking Strength (RBS) of the strand accommodated.

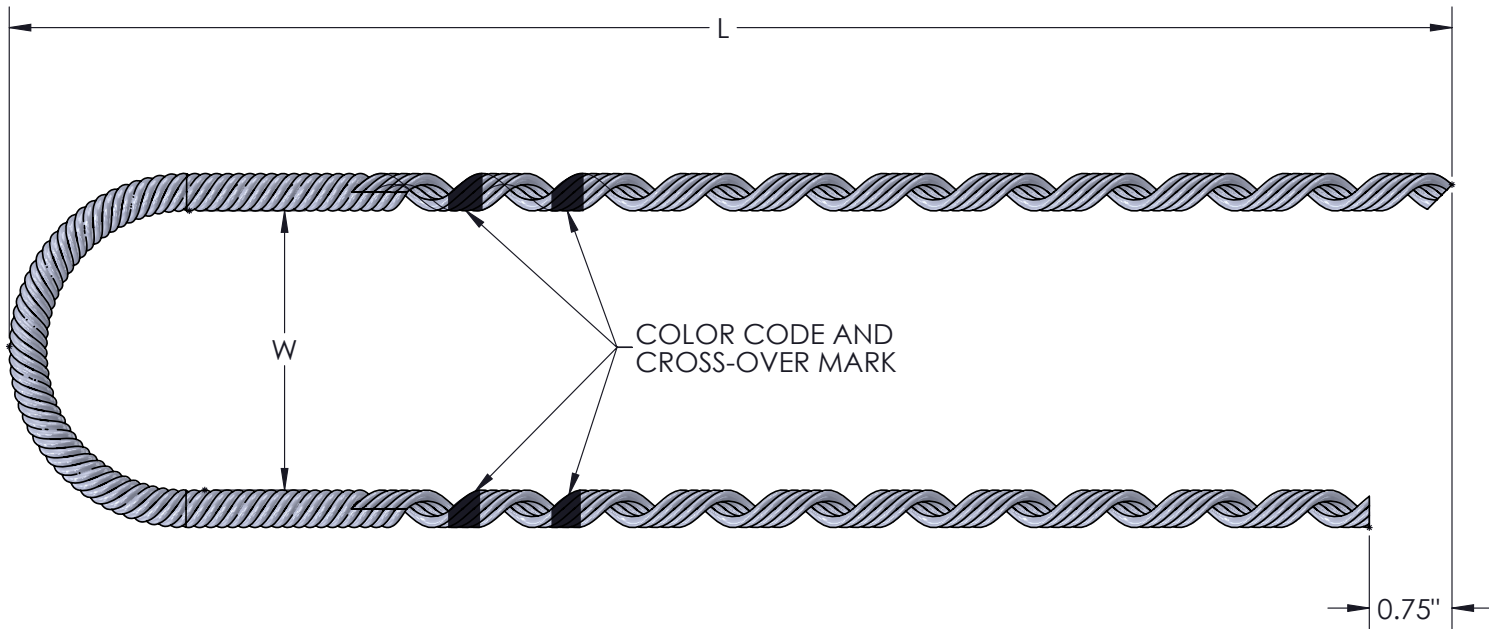

PART NUMBER		SIZE (IN)	MAX. RBS (LBS)	LENGTH (IN)	COLOR	CTN. QTY.	CTN. SIZE (IN)	CARTON WEIGHT (LBS)
ASTM A475 CLASS B	ASTM A475 CLASS C (GALFAN COATED*)							
AB110040	AB910040	1/4"	6650	25"	YELLOW	50	35" x 6" x 4"	36
AB110060	AB910060	5/16"	11200	31"	BLACK	30	35" x 6" x 4"	24
AB110070	AB910070	3/8"	15400	35"	ORANGE	25	39" x 6" x 4"	28
AB110080		7/16"	20800	37"	GREEN	20	39" x 6" x 4"	31
AB110090		1/2"	25000	44"	BLUE	10	46" x 6" x 4"	28

\* 5% ALUMINUM

## Guy Wire Splice

- Used to join or repair guy strands.
- Holding Strength is greater than the Rated Breaking Strength (RBS) of the strand accommodated.

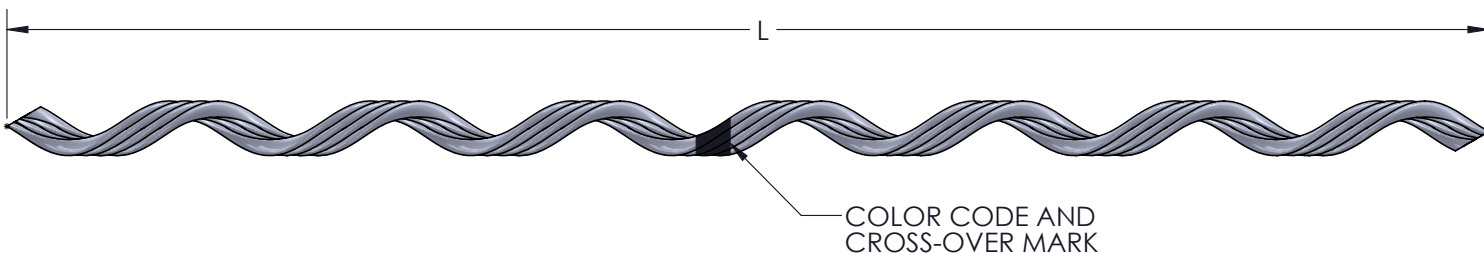
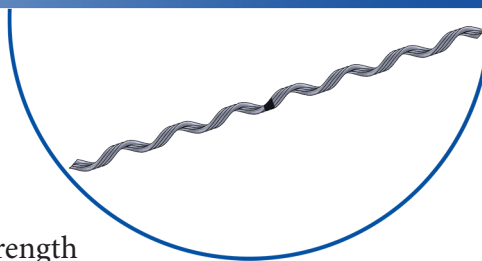

PART NUMBER		SIZE (IN)	MAX. RBS (LBS)	LENGTH (IN)	COLOR	CTN. QTY.	BOX SIZE (IN)	CARTON WEIGHT (LBS)
ASTM A475 CLASS B	ASTM A475 CLASS C (GALFAN COATED*)							
ABS1104	ABS9104	1/4"	6650	35"	YELLOW	50	35" x 6" x 4"	40
ABS1106	ABS9106	5/16"	11200	42"	BLACK	50	43" x 6" x 4"	40
ABS1107	ABS9107	3/8"	15400	50"	ORANGE	25	50" x 6" x 4"	32
ABS1108		7/16"	20800	56"	GREEN	20	57" x 6" x 4"	30
ABS1109		1/2"	25000	63"	BLUE	10	64" x 6" x 4"	36

\* 5% ALUMINUM

## False Wire Deadend

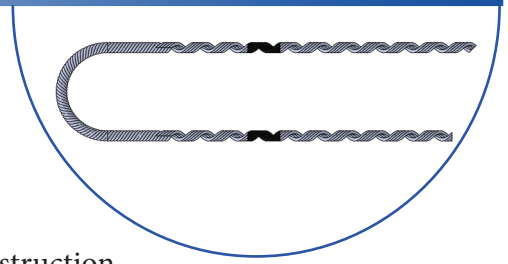

- False Deadending is used in aerial construction when:
  - Slack span construction is used.
  - The lead changes from short span to long span construction.
  - A long span falls between adjacent short spans.
- False Dead-Ends have the same strength rating as the strand they support.
- Provided with a left hand lay.
- Galvanized to meet ASTM A475 Class C (Galfan coated).

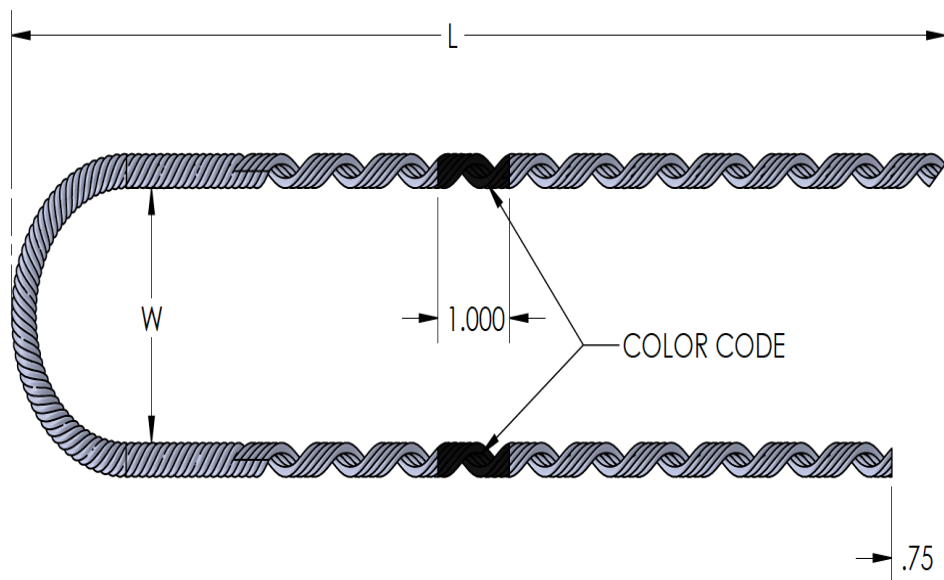

PART NUMBER ASTM A475 CLASS C (GALFAN COATED*)	SIZE (IN)	STRAND CONSTRUCTION	NO. OF WIRES	WIRE DIAMETER (IN)	MEAN DIA. (IN)	L (IN)	W (IN)	PITCH (IN)	COLOR CODE	CTN. QTY.	CTN. SIZE (IN)	CARTON WEIGHT (LBS)
ABFDE9104	1/4"	3W-7W	5	.086"	.240" - .259"	36"	2"	2" ±1/8"	YELLOW	50	37 1/2" x 11" x 4 3/4"	33
ABFDE9106	5/16"	3W-7W	5	.100"	.312" - .327"	39"	2.25"	1-5/8" ±1/8"	BLACK	50	41" x 11" x 4 3/4"	46
ABFDE9107	3/8"	3W-7W	6	.100"	.350" - .362"	42"	2.25"	2-1/8" ±1/8"	BROWN	30	51" x 8" x 4"	38

\* 5% ALUMINUM

## Automatic Guy Strand Deadend

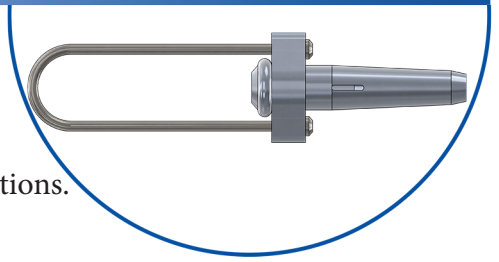

- Used to dead-end strand in guying or overhead applications.
- Holds up to 90% of the Rated Breaking Strength (RBS) of wire used.

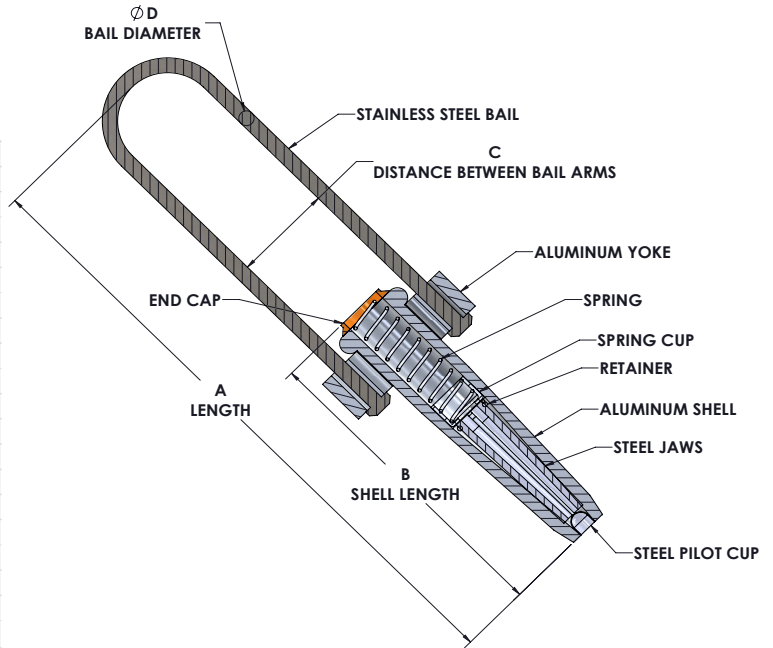

PART NUMBER	EHS	COMMON GRADE	UTILITY GRADE	SIEMENS MARTIN	BELL SYSTEM	ALUMOWELD*
AB509900	⚡					
AB510000		⚡				
AB510000L		⚡				
AB510100		⚡				
AB510100L		⚡				
AB510100LL		⚡				
AB510200		⚡				
AB510200L		⚡				
AB510200LL		⚡				
AB520000	⚡					
AB520000L		⚡				
AB520100	⚡					
AB520100L		⚡				
AB520100LL		⚡				
AB520200	⚡					
AB520200L		⚡				
AB520300M	⚡					
AB520300LM		⚡				
AB520400	⚡					

PART NUMBER	SIZE (IN)	GRADE	RANGE (IN)	A (IN)	B (IN)	C (IN)	D (IN)	END CAP COLOR	CTN. QTY.	CTN. SIZE (IN)	CARTON WEIGHT (LBS)
AB509900	3/16"	ALL GRADE	.138" - .217"	9 <sup>39</sup> / <sub>64</sub> "	4 <sup>49</sup> / <sub>64</sub> "	1 <sup>37</sup> / <sub>64</sub> "	11/64"	RED	50	36" x 24" x 16"	22
AB510000	1/4"	ALL GRADE	.240" - .272"	9 <sup>11</sup> / <sub>64</sub> "	3 <sup>31</sup> / <sub>32</sub> "	1 <sup>39</sup> / <sub>64</sub> "	13/64"	YELLOW	50	36" x 24" x 13.5"	19
AB510000L	1/4"	ALL GRADE	.240" - .272"	12 <sup>53</sup> / <sub>64</sub> "	3 <sup>31</sup> / <sub>32</sub> "	1 <sup>39</sup> / <sub>64</sub> "	13/64"	YELLOW	50	36" x 24" x 16"	23
AB510100	5/16"	ALL GRADE	.307" - .343"	9 <sup>7</sup> / <sub>32</sub> "	4 <sup>29</sup> / <sub>64</sub> "	1 <sup>31</sup> / <sub>64</sub> "	17/64"	BLACK	50	36" x 24" x 18"	34
AB510100L	5/16"	ALL GRADE	.307" - .343"	13 <sup>1</sup> / <sub>2</sub> "	4 <sup>29</sup> / <sub>64</sub> "	1 <sup>31</sup> / <sub>64</sub> "	17/64"	BLACK	50	36" x 24" x 20"	40
AB510100LL	5/16"	ALL GRADE	.307" - .343"	24"	4 <sup>29</sup> / <sub>64</sub> "	1 <sup>31</sup> / <sub>64</sub> "	17/64"	BLACK	50	62" x 22" x 18.5"	50
AB510200	3/8"	ALL GRADE	.360" - .405"	11 <sup>37</sup> / <sub>64</sub> "	5 <sup>13</sup> / <sub>64</sub> "	1 <sup>39</sup> / <sub>64</sub> "	5/16"	ORANGE	50	43" x 27" x 20"	53
AB510200L	3/8"	ALL GRADE	.360" - .405"	17"	5 <sup>13</sup> / <sub>64</sub> "	1 <sup>39</sup> / <sub>64</sub> "	5/16"	ORANGE	50	40" x 30" x 27"	56
AB510200LL	3/8"	ALL GRADE	.360" - .405"	24"	5 <sup>13</sup> / <sub>64</sub> "	1 <sup>39</sup> / <sub>64</sub> "	5/16"	ORANGE	50	72" x 18" x 14"	56
AB520000	1/4"	UNIVERSAL	.215" - .270"	9 <sup>7</sup> / <sub>8</sub> "	4 <sup>49</sup> / <sub>64</sub> "	1 <sup>39</sup> / <sub>64</sub> "	15/64"	YELLOW	25	36" x 24" x 13.5"	14
AB520000L	1/4"	UNIVERSAL	.215" - .270"	13 <sup>35</sup> / <sub>64</sub> "	4 <sup>49</sup> / <sub>64</sub> "	1 <sup>39</sup> / <sub>64</sub> "	15/64"	YELLOW	25	37" x 17" x 16"	17
AB520100	5/16"	UNIVERSAL	.270" - .315"	10 <sup>7</sup> / <sub>16</sub> "	5 <sup>23</sup> / <sub>64</sub> "	1 <sup>47</sup> / <sub>64</sub> "	9/32"	BLACK	25	36" x 24" x 13.5"	22
AB520100L	5/16"	UNIVERSAL	.270" - .315"	15 <sup>45</sup> / <sub>64</sub> "	5 <sup>23</sup> / <sub>64</sub> "	1 <sup>47</sup> / <sub>64</sub> "	9/32"	BLACK	25	50.5" x 19" x 14.5"	24
AB520100LL	5/16"	UNIVERSAL	.270" - .315"	24"	5 <sup>23</sup> / <sub>64</sub> "	1 <sup>47</sup> / <sub>64</sub> "	9/32"	BLACK	25	28.5" x 7" x 5.5"	27
AB520200	3/8"	UNIVERSAL	.325" - .392"	13 <sup>15</sup> / <sub>16</sub> "	6 <sup>27</sup> / <sub>64</sub> "	2"	5/16"	ORANGE	25	43" x 27" x 17"	36
AB520200L	3/8"	UNIVERSAL	.325" - .392"	16 <sup>31</sup> / <sub>32</sub> "	6 <sup>27</sup> / <sub>64</sub> "	2 <sup>1</sup> / <sub>8</sub> "	5/16"	ORANGE	25	61" x 22" x 14.5"	40
AB520300M	7/16"	UNIVERSAL	.392" - .455"	14 <sup>49</sup> / <sub>64</sub> "	6 <sup>11</sup> / <sub>16</sub> "	2 <sup>11</sup> / <sub>64</sub> "	25/64"	GREEN	25	43" x 27" x 20"	50
AB520300LM	7/16"	UNIVERSAL	.392" - .455"	18 <sup>15</sup> / <sub>64</sub> "	6 <sup>11</sup> / <sub>16</sub> "	2 <sup>11</sup> / <sub>64</sub> "	25/64"	GREEN	25	43" x 27" x 24"	50
AB520400	1/2"	UNIVERSAL	.455" - .520"	16 <sup>19</sup> / <sub>64</sub> "	7 <sup>3</sup> / <sub>32</sub> "	2 <sup>3</sup> / <sub>64</sub> "	13/32"	BLUE	25	43" x 27" x 24"	54

## Automatic Guy Strand Splice

- Used to splice strands in guying and overhead applications.
- Holds up to 90% of the rated breaking strength of the strand.

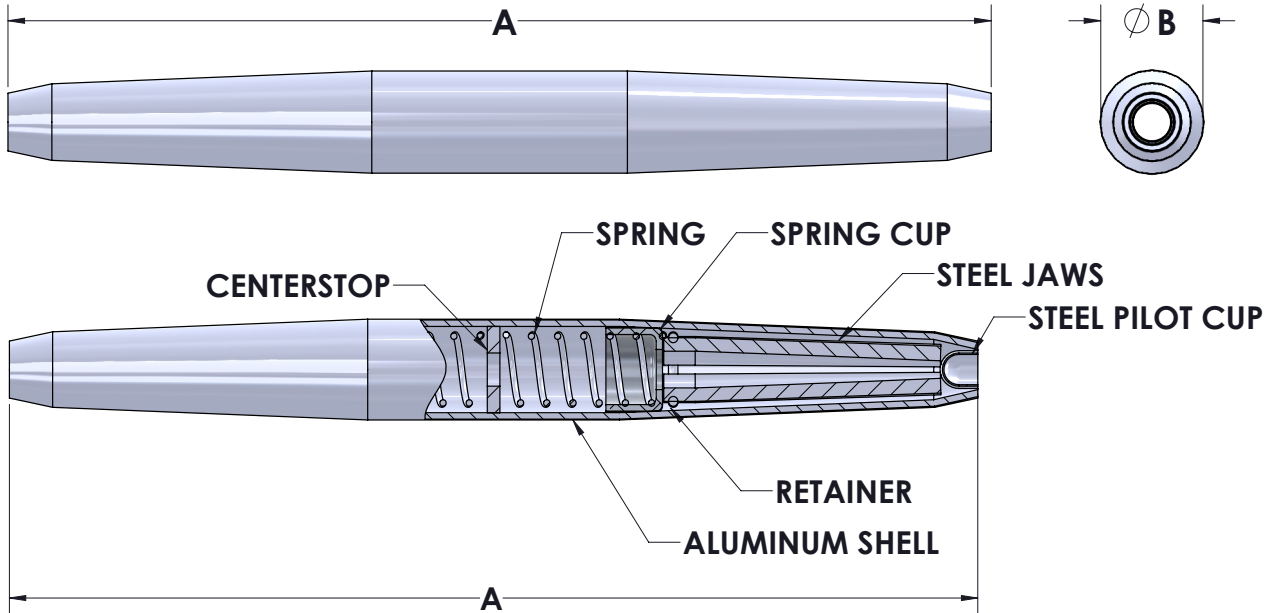
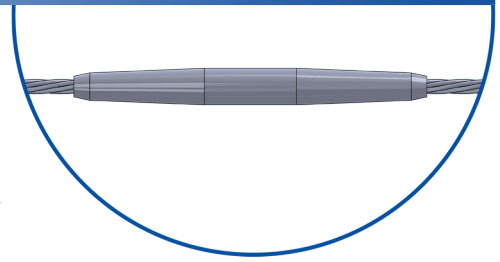

PART NUMBER	EHS	COMMON GRADE	UTILITY GRADE	SIEMENS MARTIN	BELL SYSTEM	ALUMOWELD®
AB500000	⚡					
AB500100	⚡					
AB500200	⚡					
AB504000	⚡	⚡	⚡	⚡	⚡	⚡
AB504100	⚡	⚡	⚡	⚡	⚡	⚡
AB504200	⚡	⚡	⚡	⚡	⚡	⚡
AB504300	⚡	⚡	⚡	⚡	⚡	⚡
AB504400	⚡	⚡	⚡	⚡	⚡	⚡

PART NUMBER	SIZE (IN)	GRADE	WIRE RANGE (IN)	A (IN)	B (IN)	CTN. QTY.	CTN SIZE (IN)	CARTON WEIGHT (LBS)
AB500000	1/4"	ALL GRADE	0.240"-0.272"	6 <sup>27</sup> / <sub>64</sub> "	29/32"	50	25" x 19" x 13"	16
AB500100	5/16"	ALL GRADE	0.307"-0.343"	7 <sup>23</sup> / <sub>64</sub> "	1 <sup>7</sup> / <sub>64</sub> "	50	36" x 24" x 14"	29
AB500200	3/8"	ALL GRADE	0.354"-0.378"	8 <sup>17</sup> / <sub>64</sub> "	1 <sup>19</sup> / <sub>64</sub> "	50	43" x 27" x 17"	43
AB504000	1/4" EHS	UNIVERSAL	0.215"-0.270"	8 <sup>17</sup> / <sub>64</sub> "	1 <sup>1</sup> / <sub>8</sub> "	50	36" x 24" x 14"	29
AB504100	5/16" EHS	UNIVERSAL	0.270"-0.315"	8 <sup>35</sup> / <sub>64</sub> "	1 <sup>7</sup> / <sub>32</sub> "	50	36" x 24" x 16"	37
AB504200	3/8" EHS	UNIVERSAL	0.325"-0.392"	10 <sup>15</sup> / <sub>64</sub> "	1 <sup>15</sup> / <sub>32</sub> "	25	36" x 24" x 14"	30
AB504300	7/16" EHS	UNIVERSAL	0.413"-0.449"	10 <sup>53</sup> / <sub>64</sub> "	1 <sup>19</sup> / <sub>32</sub> "	25	36" x 24" x 18"	38
AB504400	1/2" EHS	UNIVERSAL	0.455"-0.520"	12 <sup>13</sup> / <sub>64</sub> "	1 <sup>11</sup> / <sub>16</sub> "	25	43" x 27" x 17"	49

## Strand Reducing Splice

- Used to splice different strand sizes in guying and overhead applications.
- Holds up to 90% of the rated breaking strength of the Strand.

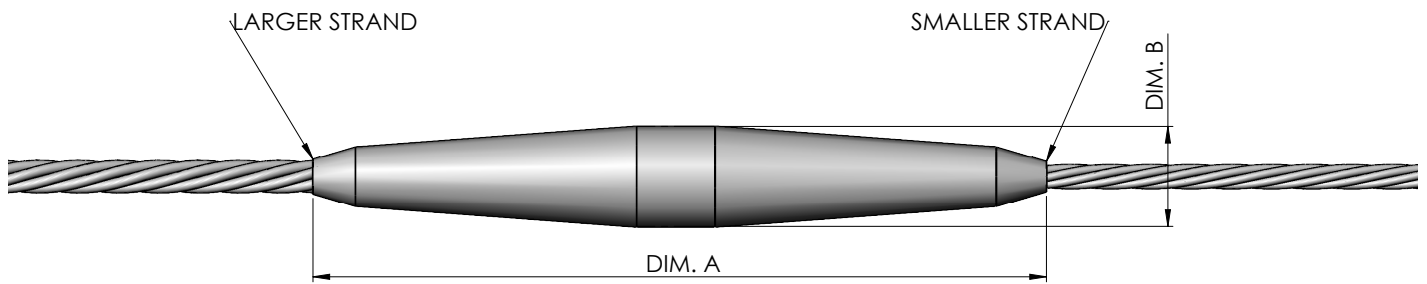
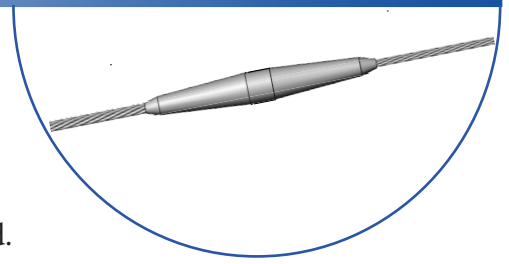

PART NUMBER	PRIMARY STRAND APPLICATION (IN)	RANGE LARGE END (IN)	RANGE SMALL END (IN)	DIM. A (IN)	DIM. B (IN)	CTN. QTY.	CTN. SIZE (IN)	CARTON WEIGHT (LBS)
AB508600	3/16" & 1/4"	0.215"-0.270"	0.145"-0.215"	8.30"	1.12"	50	14.2" x 9.4" x 6.2"	34
AB508700	1/4" & 5/16"	0.270"-0.315"	0.215"-0.270"	9.00"	1.22"	50	14.2" x 9.4" x 6.2"	27
AB502200	5/16" & 3/8"	0.360"-0.405"	0.310"-0.335"	10.40"	1.48"	25	14.2" x 9.4" x 6.2"	27
AB502300	3/8" & 7/16"	0.410"-0.455"	0.360"-0.405"	11.50"	1.59"	25	16.9" x 10.6" x 6.6"	36



## Messenger Support Wire Deadend

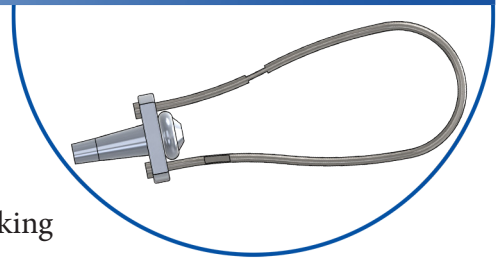

- Used as a Dead-end support for Figure 8 Cable.
- The minimum holding strength is 90% of the rated breaking strength of the support wire.

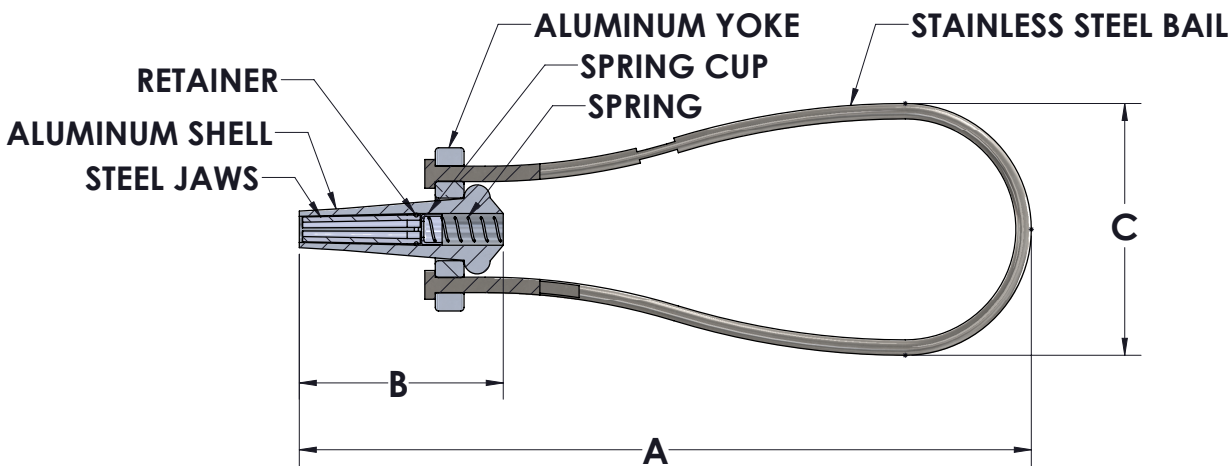
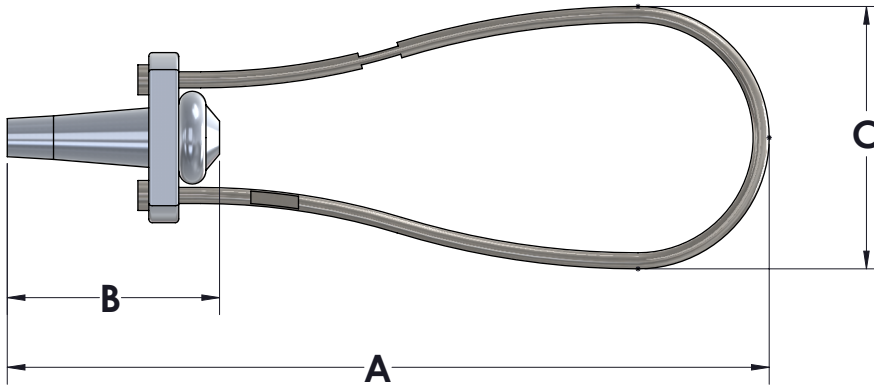

PART NUMBER	WIRE RANGE (IN)	A (IN)	B (IN)	C (IN)	CTN. QTY.	CTN. SIZE (IN)	CARTON WEIGHT (LBS)
AB505600	0.062"-0.100"	5 <sup>1</sup> / <sub>2</sub> "	1 <sup>9</sup> / <sub>16</sub> "	1 <sup>5</sup> / <sub>8</sub> "	50	25" x 15" x 11"	4
AB505800	0.091"-0.100"	5 <sup>1</sup> / <sub>2</sub> "	1 <sup>1</sup> / <sub>2</sub> "	1 <sup>5</sup> / <sub>8</sub> "	50	25" x 15" x 11"	4
AB506200	0.120"-0.135"	7 <sup>3</sup> / <sub>4</sub> "	2 <sup>1</sup> / <sub>2</sub> "	1 <sup>1</sup> / <sub>2</sub> "	50	29" x 29" x 8"	9
AB519900	0.140"-0.215"	10 <sup>1</sup> / <sub>4</sub> "	4 <sup>5</sup> / <sub>8</sub> "	1 <sup>5</sup> / <sub>8</sub> "	50	36" x 24" x 16"	22

## Messenger Support Wire Splice

- The minimum holding strength is 90% of the rated breaking strength of the support wire.
- Used to splice the support wire of Figure 8 Drop Cable.

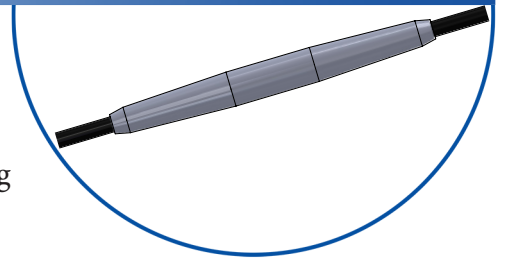

October 2023

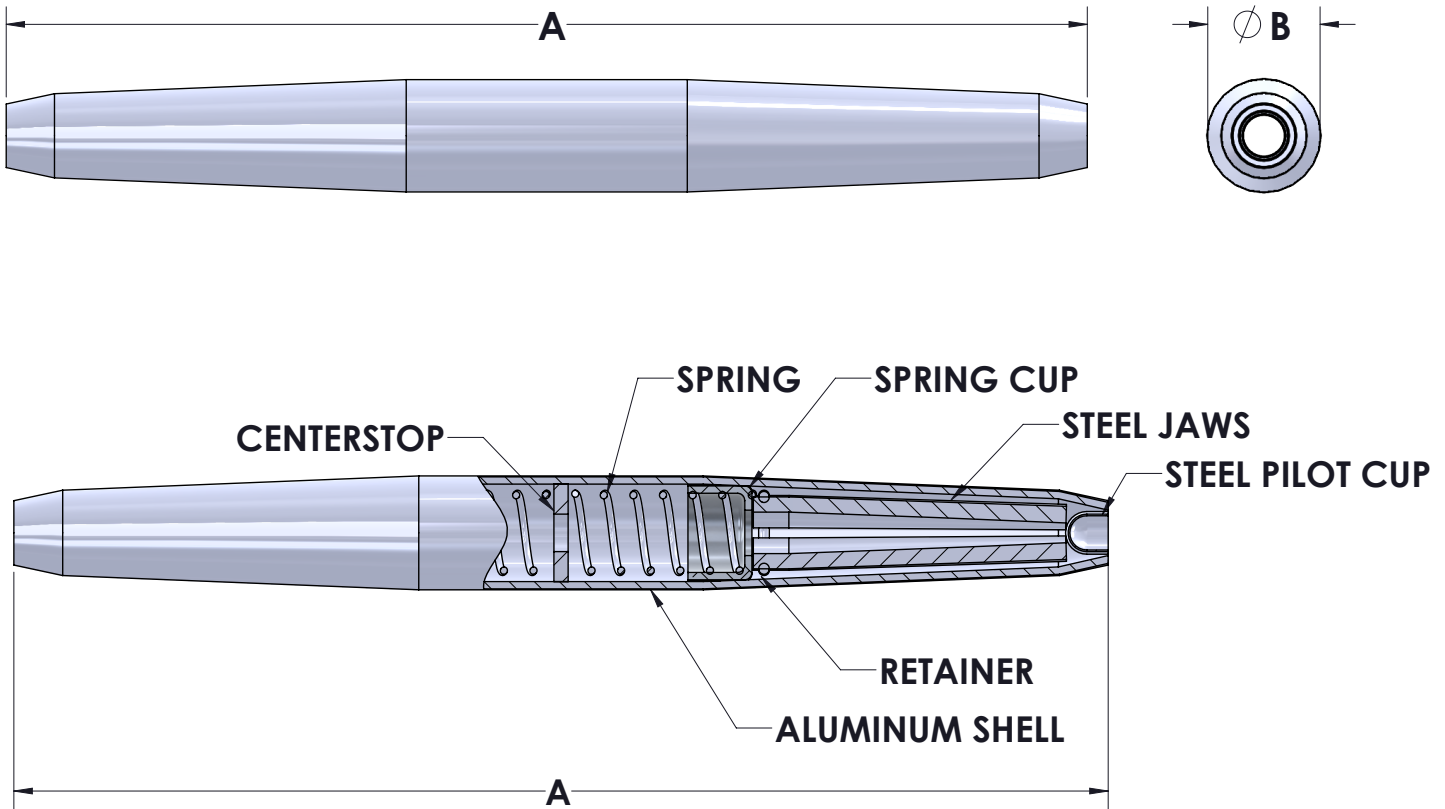

PART NUMBER	WIRE RANGE (IN)	A (IN)	B (IN)	C (IN)	CTN. QTY.	CTN. SIZE (IN)	CARTON WEIGHT (LBS)
AB505600	0.062"-0.100"	5 <sup>1</sup> / <sub>2</sub> "	1 <sup>9</sup> / <sub>16</sub> "	1 <sup>5</sup> / <sub>8</sub> "	50	25" x 15" x 11"	4
AB505800	0.091"-0.100"	5 <sup>1</sup> / <sub>2</sub> "	1 <sup>1</sup> / <sub>2</sub> "	1 <sup>5</sup> / <sub>8</sub> "	50	25" x 15" x 11"	4
AB506200	0.120"-0.135"	7 <sup>3</sup> / <sub>4</sub> "	2 <sup>1</sup> / <sub>2</sub> "	1 <sup>1</sup> / <sub>2</sub> "	50	29" x 29" x 8"	9
AB519900	0.140"-0.215"	10 <sup>1</sup> / <sub>4</sub> "	4 <sup>5</sup> / <sub>8</sub> "	1 <sup>5</sup> / <sub>8</sub> "	50	36" x 24" x 16"	22

## Z Bail Aluminum Dead-End

- Used to deadend ACSR, AAAC, and AAC Conductor.
- Color coded funnel for easy identification; please see chart for Conductor Size and Approximate Conductor O.D.
- Galvanized Steel Clevis pin and Stainless Steel cotter pin enable the bail to be used with standard deadend suspension insulators.
- Microcrystalline based inhibitor coats the jaws and tube's inside walls to help seal the connection and provide a high pressure lubricant for long-term performance.
- Manufactured from high-strength Aluminum.
- Breaking Strength exceeds 95% of conductor's rated strength, up to a maximum of 10,000 LBS.

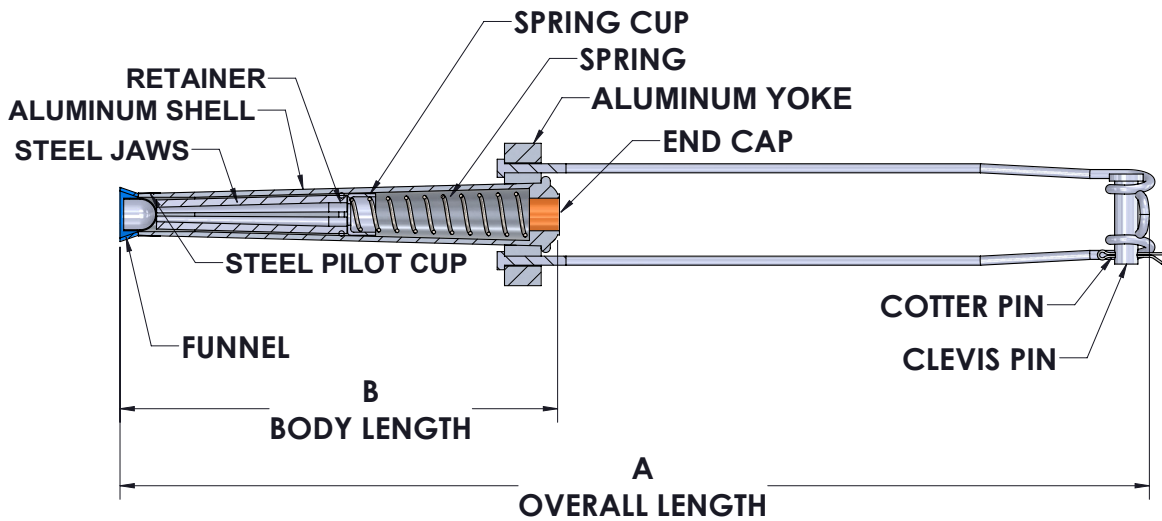
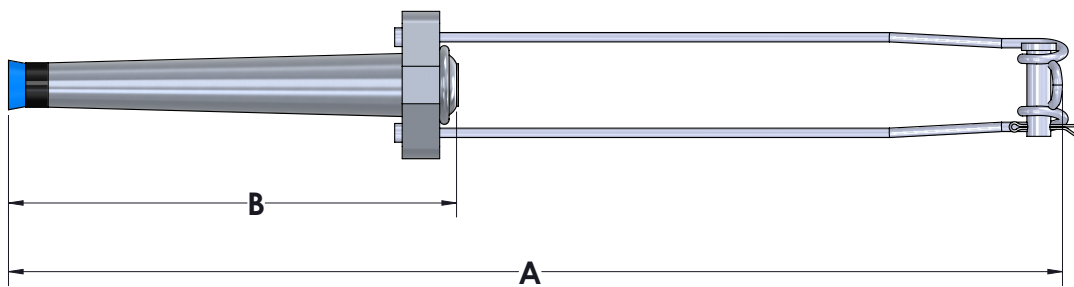
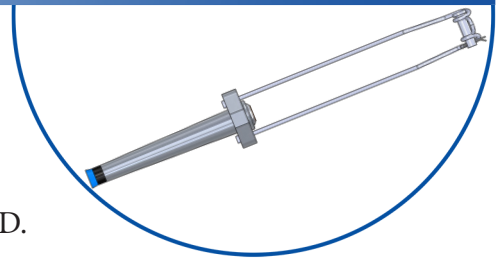

PART NUMBER	CONDUCTOR SIZE			APROXIMATE CONDUCTOR OD. (IN)	COLOR CODE	A (IN)	B (IN)	CTN. QTY.	CTN. SIZE (IN)	CARTON WEIGHT (LBS)
	ACSR	AAAC	AAC							
AB760100Z	#4 - #2	#4 - #2	#4 - #2	.220" - .320"	RED-ORANGE	14"	8"	50	38" x 30" x 13"	50
AB760200Z	1/0 -2/0	1/0 -2/0	1/0 -2/0	.355" - .470"	GRAY-YELLOW	14.2"	8.2"	50	38" x 30" x 13"	52
AB760300Z	3/0 -4/0	3/0 -4/0	3/0 -4/0	.464" - .595"	PINK-BLACK	21.2"	12"	50	44" x 38" x 13"	52
AB760400Z	266.8 - 336.4 (18/1)	312.8 - 394.5	336.4 - 397.5	.603" - .724"	GREEN-BROWN	21.2"	12"	20	22" x 21" x 17"	46
AB760500Z	397.5 (18/1)	465.4	477	.720" - .795"	BLUE	21.1"	12"	15	22" x 21" x 13"	42
AB760600Z	477 (18/1)	559.5	556.5 - 500	.780" - .858"	WHITE	21.2"	12"	15	22" x 21" x 13"	42

## Clevis Bail Aluminum Dead-End

- Used to deadend ACSR, AAAC, and AAC Conductor.
- Color coded funnel for easy identification; please see chart for Conductor Size and Approximate Conductor O.D.
- Galvanized Steel Clevis pin and Stainless Steel cotter pin enable the bail to be used with standard deadend suspension insulators.
- Microcrystalline based inhibitor coats the jaws and tube's inside walls to help seal the connection and provide a high pressure lubricant for long-term performance.
- Slots on side of bail are provided for use with standard polling hooks.
- Breaking Strength exceeds 95% of conductor's rated strength, up to a maximum of 10,000 LBS.

October 2023

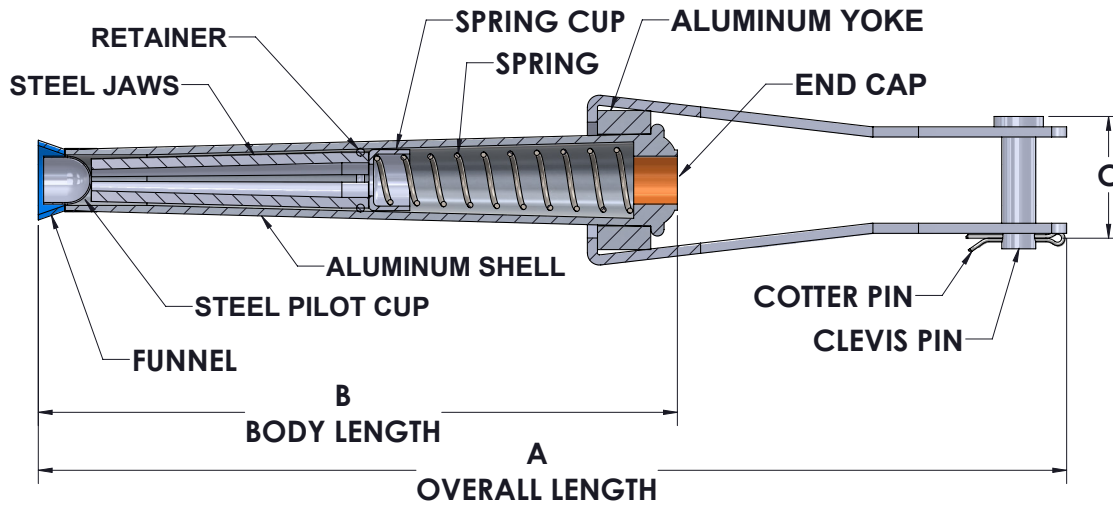
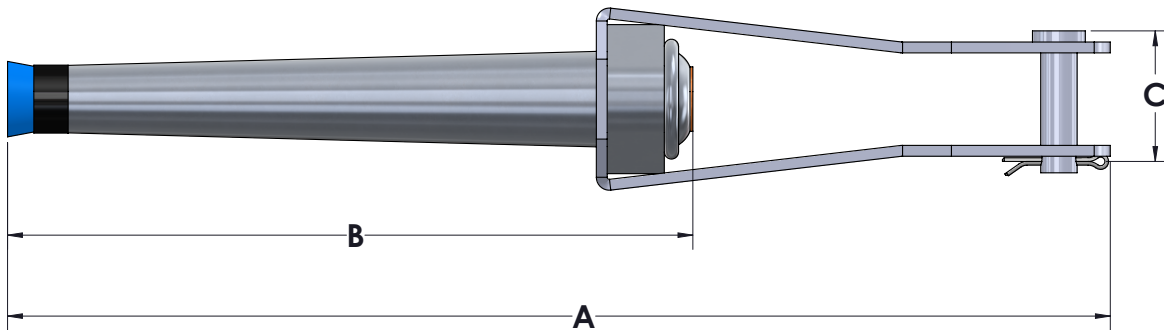
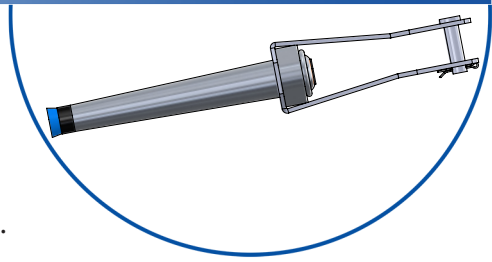

PART NUMBER	CONDUCTOR SIZE			APROXIMATE CONDUCTOR OD. (IN)	COLOR CODE	A (IN)	B (IN)	C (IN)	CTN. QTY.	CTN. SIZE (IN)	CARTON WEIGHT (LBS)
	ACSR	AAAC	AAC								
AB760100C	#4 - #2	#4 - #2	#4 - #2	.220" - .320"	RED-ORANGE	14.2"	8"	1.6"	25	21" x 21" x 15"	35
AB760200C	1/0 - 2/0	1/0 - 2/0	1/0 - 2/0	.355" - .470"	GRAY-YELLOW	14.2"	8.2"	1.6"	25	21" x 21" x 15"	35
AB760300C	3/0 - 4/0	3/0 - 4/0	3/0 - 4/0	.464" - .595"	PINK-BLACK	19"	12"	2"	25	21" x 21" x 20"	43
AB760400C	266.8 - 336.4 (18/1)	312.8 - 394.5	336.4 - 397.5	.603" - .724"	GREEN-BROWN	19"	12"	2.2"	15	21" x 20" x 13"	44
AB760500C	397.5 (18/1)	465.4	477	.720" - .795"	BLUE	19"	12"	2.2"	15	21" x 20" x 13"	52
AB760600C	477 (18/1)	559.5	556.5 - 500	.780" - .858"	WHITE	19"	12"	2.2"	15	21" x 20" x 13"	51

## Flexible Bail Aluminum Dead-End

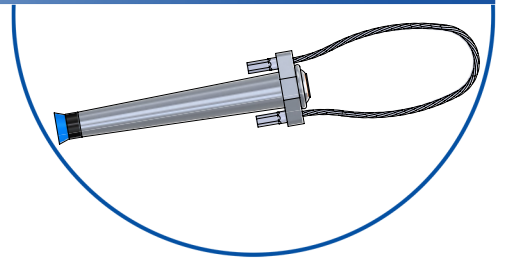

- Used to deadend ACSR, AAAC, and AAC Conductor.
- Color coded funnel for easy identification; please see chart for Conductor Size and Approximate Conductor O.D.
- Versatile Flexible Stainless Steel bail for use with spool type insulators and other types of insulators where flexibility is necessary.
- Manufactured from high-strength Aluminum.
- Microcrystalline based inhibitor coats the jaws and tube's inside walls to help seal the connection and provide a high pressure lubricant for long-term performance.
- Breaking Strength exceeds 95% of conductor's rated strength, up to a maximum of 10,000 LBS.

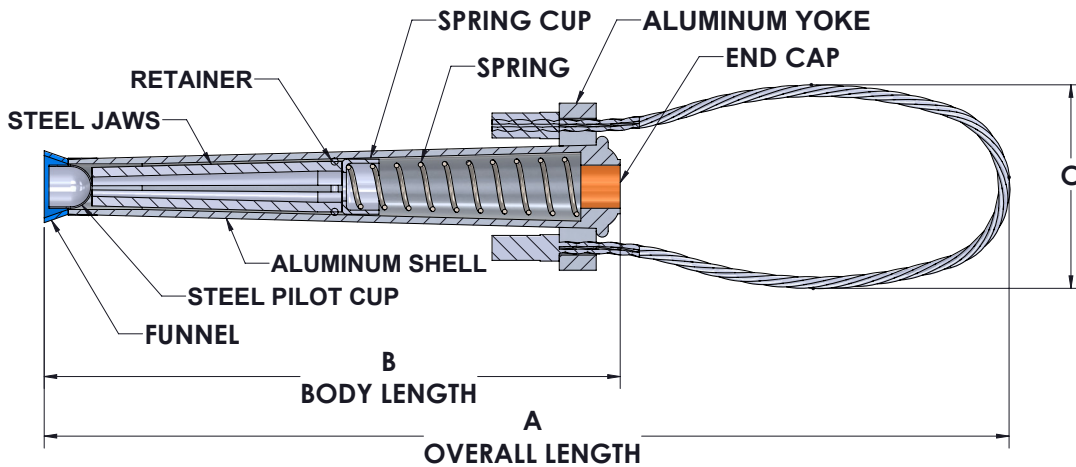
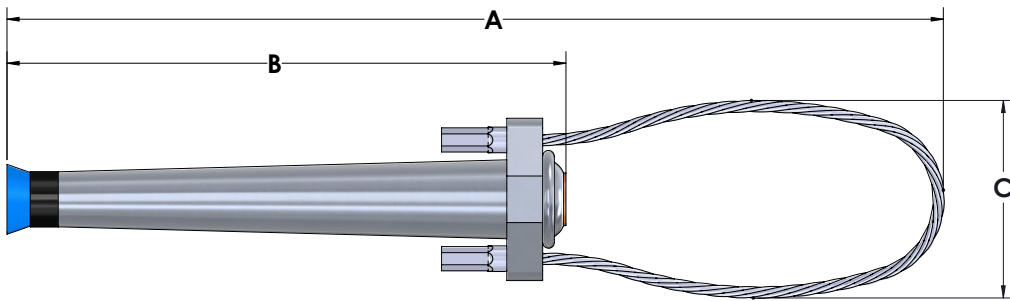

PART NUMBER	CONDUCTOR SIZE			APROXIMATE CONDUCTOR OD. (IN)	COLOR CODE	A (IN)	B (IN)	C (IN)	CTN. QTY.	CTN. SIZE (IN)	CARTON WEIGHT (LBS)
	ACSR	AAAC	AAC								
AB760100F	#4 - #2	#4 - #2	#4 - #2	.220" - .320"	RED-ORANGE	16"	8"	4"	50	38" x 33" x 13"	50
AB760200F	1/0 - 2/0	1/0 - 2/0	1/0 - 2/0	.355" - .470"	GRAY-YELLOW	16"	8.2"	4.5"	50	44" x 33" x 14"	50
AB760300F	3/0 - 4/0	3/0 - 4/0	3/0 - 4/0	.464" - .595"	PINK-BLACK	23.2"	12"	6.7"	25	35" x 35" x 24"	44
AB760400F	266.8 - 336.4 (18/1)	312.8 - 394.5	336.4 - 397.5	.603" - .724"	GREEN-BROWN	23.4"	12"	6"	20	31" x 25" x 25"	40
AB760500F	397.5 (18/1)	465.4	477	.720" - .795"	BLUE	23.7"	12"	5.7"	15	31" x 25" x 25"	38
AB760600F	477 (18/1)	559.5	556.5 - 500	.780" - .858"	WHITE	23.5"	12"	6.2"	15	31" x 25" x 25"	37

- Used to splice Aluminum Conductors in overhead construction.
- Both shell and jaws are manufactured from high-strength Aluminum.
- Color coded ends provide easy identification; please see chart for Conductor Size and Approximate Conductor O.D.
- Funnel ends allow for easy insertion.
- Center stop provides simple means for determining proper insertion length of both conductors.
- Microcrystalline based inhibitor coats the jaws and tube's inside walls to help seal the connection and provide a high pressure lubricant for long-term performance.
- Breaking Strength exceeds 95% of conductor's rated strength, up to a maximum of 10,000 LBS.
- Allied Bolt Aluminum Conductor Splices meet ANSI Specification C119.4 for full tension class A connectors.

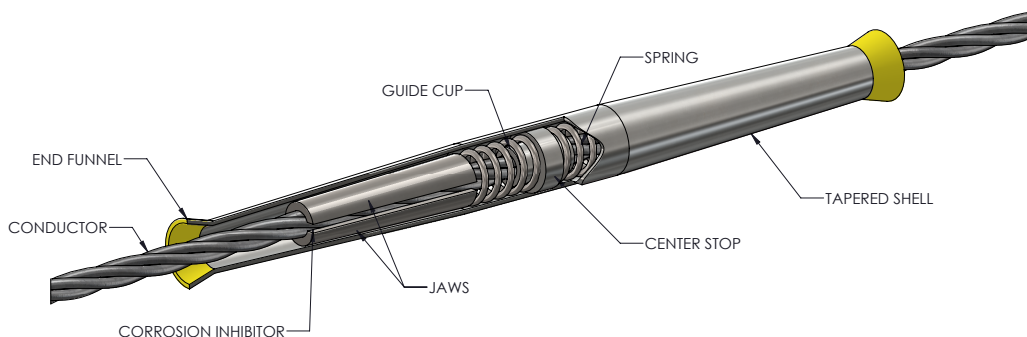
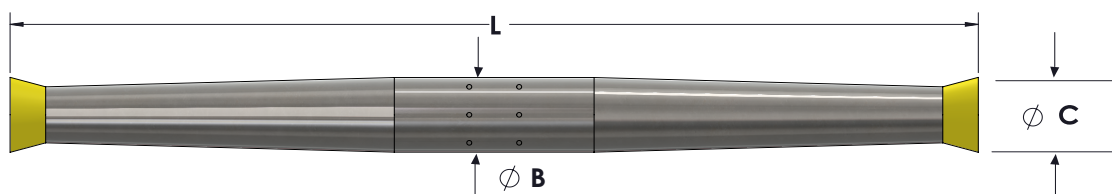
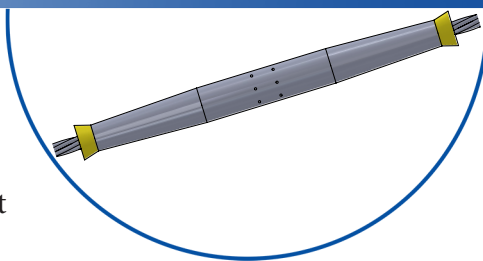

PART NUMBER	LENGTH (L) (IN)	DIAMETER (B) (IN)	DIAMETER (C) (IN)	CONDUCTOR SIZE			APPROXIMATE CONDUCTOR OD. (IN)	FUNNEL COLOR CODE	A (IN)	B (IN)	CTN. QTY.	CTN. SIZE (IN)	CARTON WEIGHT (LBS)
				ACSR	AAAC	AAC							
AB40100	11-13/16	29/32	3/4	#6 - #4	#6 - #4	#6 - #4	.184" - .263"	BLUE	26"	2.1"	50	34" x 26" x 13"	14
AB40200	11-13/16	29/32	3/4	#4	#4	#4	.220" - .250"	ORANGE	9"	0.9"	20	34" x 26" x 13"	14
AB40420	13-25/32	1	13/16	#4 - #2	#4 - #2	#4 - #2	.220" - .320"	RED-ORANGE	12"	1.1"	20	38" x 28.5" x 13.5"	20
AB40600	13-25/32	1-1/8	1-1/32	1/2	1/0	1/0	.335" - .400"	YELLOW	12"	1.1"	20	38" x 31" x 15"	28
AB407600	15-13/64	1-9/32	1-7/64	1/0 - 2/0	1/0 - 2/0	1/0 - 2/0	.355" - .470"	YELLOW-GRAY	18.7"	1.4"	25	42" x 30" x 10"	19
AB40700	17-21/64	1-25/64	1-7/64	2/0	2/0	2/0	.400" - .407"	GRAY	18"	1.4"	20	48" x 19" x 20"	26
AB40800	18-27/64	1-1/2	1-13/64	3/0	3/0	3/0	.450" - .530"	BLACK	18"	1.5"	25	49" x 20" x 20"	32
AB40900	22-3/64	1-45/64	1-21/64	4/0	4/0	4/0	.505" - .595"	PINK	17"	1.6"	20	57" x 32" x 13"	41
AB409800	23	1-45/64	1-21/64	266.8 (18/1) -336.4 (18/1)	3/0	3/0	.603" - .724"	PINK-BLACK	23"	1.6"	20	62" x 24.5" x 17"	40
AB41000*	18-45/64	1-21/32	1-5/16	266.8 (18/1)	312.8	336.4	.603" - .666"	BROWN	19"	1.7"	20	52" x 23.5" x 22.5"	34
AB4111000*	22-3/64	1-27/32	1-27/64	266.8 (18/1) - 336.4 (18/1)			.603" - .666"	GREEN-BROWN	21"	1.8"	20	59" x 24" x 21"	40
AB41100*	20-15/64	1-27/32	1-29/64	336.4 (18/1)	394.5	397.5 336.4	.659" - .724"	GREEN	20"	1.8"	20	55" x 24.5" x 11.5"	19
AB41200*	24-21/32	2-9/64	1-19/32	397.5 (18/1)	465.4	477	.720" - .795"	BLUE	22"	2.1"	10	64" x 28.5" x 12"	31
AB41300*	23-15/64	2-9/64	1-43/64	477 (18/1)	559.5	556.5 - 500	.780" - .858"	WHITE	24"	2.1"	20	62" x 28.5" x 13"	28

\* For Multi Layer Strand Conductors.



## Automatic Copper Splices

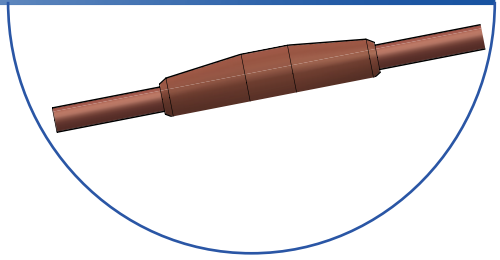

- Efficient means of splicing copper conductors
- Holding capacities:
  - Solid; 90% of Conductor rated breaking strength
  - Stranded; 80% of conductor rated breaking strength
  - Copperweld; 75% of Conductor rated breaking strength
- Protected with inhibitor for maximum performance
- Individually packaged to keep out dirt and debris

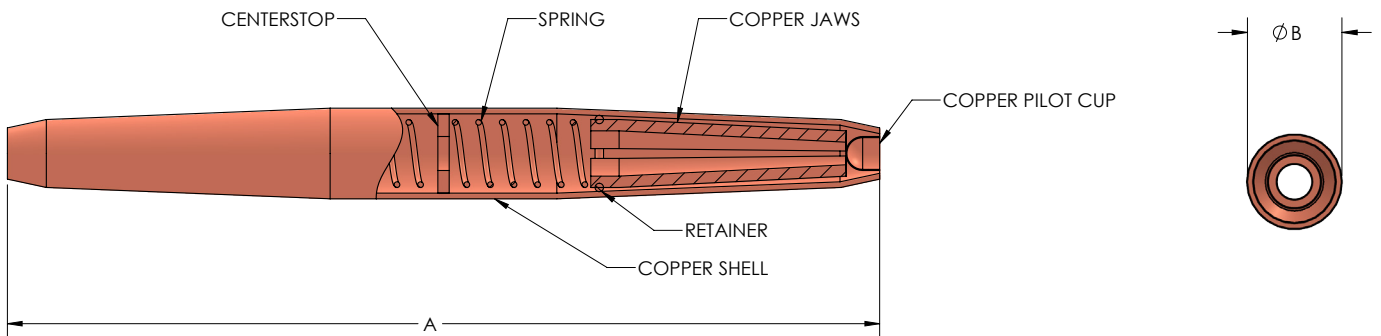

PART NUMBER	COPPER CONDUCTOR			CONDUCTOR DIAMETER RANGE (IN)	A SPLICE LENGTH (IN)	B SPLICE DIAMTER (IN)	PCS/CTN	PCS/PALLET	CARTON SIZE (INCHES)			CARTON WEIGHT (LBS)
	SOL	STR	C.W.						L (IN)	W (IN)	H (IN)	
CUS1	#8 - #6	8	3 NO. 12	0.120" - .0165"	3.74"	.53"	100	16800	10"	6"	4.5"	13
CUS2	#4	6	8A	0.161" - 0.203"	3.90"	.59"	100	10800	10"	7.5"	5.5"	15
CUS3	#3	-	6A	0.203" - 0.230"	5.71"	.75"	50	5400	10"	7.5"	5.5"	18
CUS4	#2	4 - 3	5A	0.230" - 0.265"	6.10"	.80"	50	3000	14.5"	9.5"	5.5"	23
CUS5	#1	2	4A	0.265" - 0.303"	6.26"	.85"	50	3000	14.5"	9.5"	5.5"	25
CUS6	1/0	1	3A	0.304" - 0.340"	6.26"	.93"	50	3000	14.5"	9.5"	5.5"	30
CUS7	2/0	1/0	2A	0.340" - 0.385"	6.97"	.97"	50	2500	14.5"	9.5"	6.5"	34
CUS8	3/0	2/0	-	0.398" - 0.420"	7.13"	1.02"	50	2500	14.5"	9.5"	6.5"	40
CUS9	4/0	3/0	-	0.437" - 0.476"	7.32"	1.10"	25	1500	14.5"	9.5"	5.5"	23
CUS10	-	4/0	-	0.485" - 0.540"	7.99"	1.27"	25	1500	14.5"	9.5"	5.5"	34

SIZE	GRADE	WT. LBS. PER 1000'	MIN. STRENGTH LBS.
3/16	COMMON	73	1150
3/16	UTILITY 2.2M	73	2400
1/4	COMMON	121	1900
1/4	SIEMENS MARTIN	121	3150
1/4	HIGH STRENGTH 4.7M	121	4750
1/4	EX. HIGH STRENGTH 6.6M	121	6650
5/16	COMMON	205	3200
5/16	SIEMENS MARTIN	205	5350
5/16	UTILITY GRADE 6M	225	6000
5/16	HIGH STRENGTH	205	8000
5/16	EX. HIGH STRENGTH 11.2	205	11200
3/8	COMMON	273	4250
3/8	SIEMENS MARTIN	273	6950
3/8	UTILITY 10M	273	11500
3/8	HIGH STRENGTH	273	10800
3/8	EX. HIGH STRENGTH	273	15400
7/16	SIEMENS MARTIN	399	9350
7/16	HIGH STRENGTH	399	14500
7/16	UTILITY 16M	399	18000
1/2	SIEMENS MARTIN	517	12100
1/2	HIGH STRENGTH	517	18800
1/2	UTILITY 25M	517	25000



# Cross Reference

Allied Bolt Part No.	MacLean Part No.	Hubbell Part No.	PLP Part No.	PG.
AB110040	DE-S1104	FWDE1104TE	GDE-1104	1
AB110060	DE-S1106	FWDE1106TE	GDE-1106	1
AB110070	DE-S1107	FWDE1107TE	GDE-1107	1
AB110080	DE-S1108	FWDE1108TE	GDE-1108	1
AB110090	DE-S2115	FWDE2115TE	BG-2115	1
AB910040	DE-S9014	BDE9104	GDE-2104	1
AB910060	DE-S9106	BDE9106	GDE-2106	1
AB910070	DE-S9107	BDE9107	GDE-2107	1
ABS9104	LS-S9104		BLS-9104	2
ABS9106	LS-S9106		BLS-9106	2
ABS9107	LS-S9107		BLS-9107	2
ABS1104	LS-S1104	FWLS2104	GLS-2104	2
ABS1106	LS-S1106	FWLS2106	GLS-2106	2
ABS1107	LS-S1107	FWLS2107	GLS-2107	2
ABS1108		FWLS2108	GLS-2108	2
ABS1109				2
ABFD9104		BFD9104	GFDE-2121	3
ABFD9106		BFD9106	GFDE-2123	3
ABFD9107		BFD9107	GFDE-2124	3
AB509900	5099			4
AB510000	5100	GDE5100		4
AB51000L	5100L	GDE5100L		4
AB510100	5101	GDE5101		4
AB510100L	5101L	GDE5101L		4
AB510100LL	5151			4
AB510200	5102	GDE5102		4
AB510200L	5102L	GDE5102L		4
AB510200LL	5152			4
AB520000	5200	GDE5200		4
AB52000L	5200L	GDE5200L		4
AB520100	5201	GDE5201		4
AB520100L	5201L	GDE5201L		4
AB520100LL	5251			4
AB520200	5202	GDE5202		4
AB520200L	5202L	GDE5202L		4
AB520300M	5203	GDE5203		4
AB520300LM	5203L	GDE5203L		4
AB520400	5204	GDE5204		4
AB500000	5000	GLS5000		5
AB500100	5001	GLS5001		5
AB500200	5002	GLS5002		5
AB504000	5040	GLS5040		5
AB504100	5041	GLS5041		5
AB504200	5042	GLS5042		5
AB504300	5043	GLS5043		5
AB504400	5044	GLS5044		5
AB508600	5056			6
AB508700	5087			6
AB502200	5022			6
AB502300	5023			6
AB505600	5056			7
AB505800	5058			7
AB506200	5062			7
AB519900	5199			7
AB503900	5039			8
AB505700	5057			8
AB505900	5059			8
AB506300	5063			8
AB503900	5039			8
AB760100Z	7652AP SDS	GD4042AZ		9
AB760200Z	7653 SDS	GD406AZ		9
AB760200Z	7654AP LD	GD407Z		9
AB760300Z	7656AP FD	GD408Z		9
AB760300Z	7656AP FD	GD409AZ		9
AB760400Z		GD410Z		9
AB760400Z		GD411Z		9
AB760500Z	7659SDS	GD412Z		9
AB760600Z	7659SDS			9
AB760100C	7652AP LD	GD4442A		10
AB760200C	7653 LD	GD446A		10
AB760200C	7654AP LD	GD447		10
AB760300C		GD448		10
AB760300C		GD449A		10
AB760400C		GD450		10
AB760400C		GD451		10
AB760500C				10
AB760600C				10

Allied Bolt Part No.	MacLean Part No.	Hubbell Part No.	PLP Part No.	PG.
AB760100F	7652AP FD	GD4042A		11
AB760200F	7653 FD	GD406A		11
AB760200F	7654AP FD	GD407		11
AB760300F	7656AP FD	GD408		11
AB760300F	7656AP FD	GD409A		11
AB760400F		GD410		11
AB760400F		GD411		11
AB760500F		GD412		11
AB760600F				11
AB40100		GL401		12
AB40200	7651	GL402		12
AB40420	7652AP	GL4042A		12
AB40600	7653	GL406A		12
AB407600		GL4076A		12
AB40700	7654AP	GL407		12
AB40800		GL408		12
AB40900	7656AP	GL409A		12
AB409800		GL411		12
AB41000	7658AP	GL410		12
AB411000		GL4111		12
AB41100	7658AP	GL411		12
AB41200	7659	GL412		12
AB41300	7659	GL413		12
CUS1	61, 81	GL110, GL111		13
CUS2	41	GL112, GL112M		13
CUS3		GL113		13
CUS4	21, 47	GL113, GL114		13
CUS5	27	GL115		13
CUS6	101	GL116		13
CUS7	107	GL117		13
CUS8	207	GL118		13
CUS9	307	GL119		13
CUS10	407	GL120		13



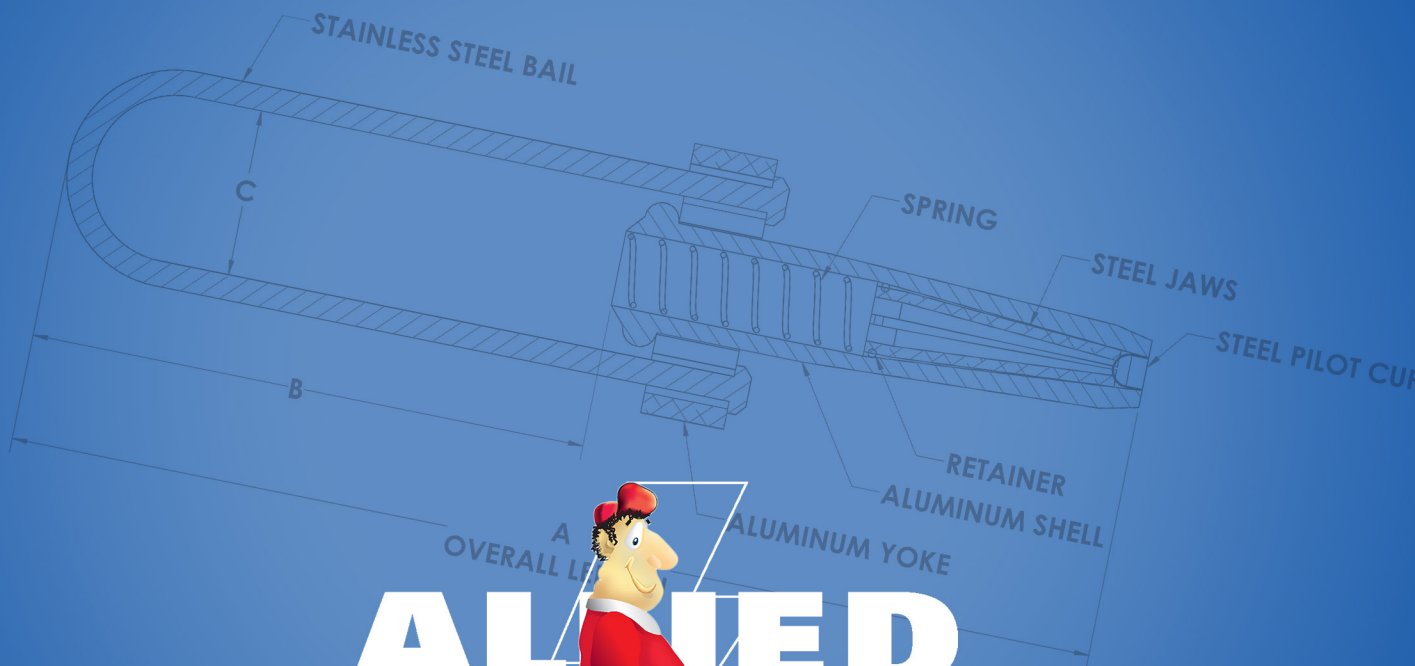

# ALLIED BOLT®

PRODUCTS, LLC



COLOR CODE AND  
CROSS-OVER MARK

[www.alliedboltinc.com](http://www.alliedboltinc.com)

Copyright © 2024 Allied Bolt Products, LLC. All rights reserved.